

**STRAIGHT BULKHEAD JACK PANEL SEAL**

**R125.325.900**

**CABLE .141**

Series : SMA

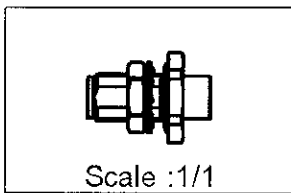
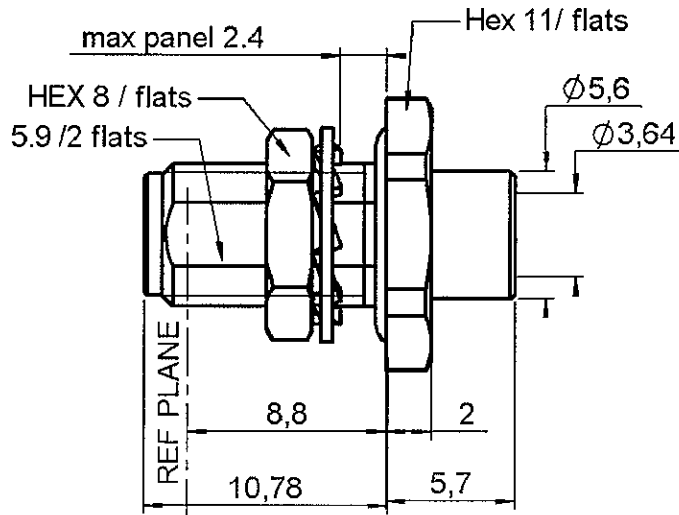

**PANEL CUT OUT**

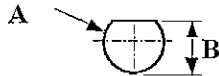

mm		
	Maxi	mini
A	6.5	6.4
B	6.15	6

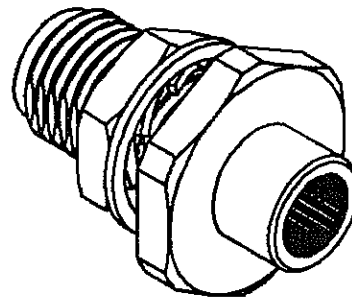

All dimensions are in mm.

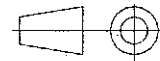

COMPONENTS	MATERIALS	PLATINGS (µm)
BODY	STAINLESS STEEL	GOLD 0.5 OVER NICKEL 2
CENTER CONTACT	BERYLLIUM COPPER	GOLD 1.3 OVER NICKEL 2
OUTER CONTACT	-	-
INSULATOR	PTFE	-
GASKET	SILICONE RUBBER	-
OTHERS PARTS	STAINLESS STEEL	PASSIVATED .
-	-	-
-	-	-

Issue : 0540 C

In the effort to improve our products, we reserve the right to make changes judged to be necessary.



**RADIALL**®

**STRAIGHT BULKHEAD JACK PANEL SEAL**

**R125.325.900**

**CABLE .141**

Series : SMA

**PACKAGING**

Standard	Unit	Other
100	'W' option	Contact us

**SPECIFICATION**

**CABLE ASSEMBLY**

**ELECTRICAL CHARACTERISTICS**

Impedance		<b>50</b> Ω
Frequency		<b>0-18</b> GHz
VSWR	<b>1.05</b> +	<b>0.010</b> x F(GHz) Maxi
Insertion loss		<b>0.03</b> √F(GHz) dB Maxi
RF leakage	- (	<b>60</b> - F(GHz) dB mini
Voltage rating		<b>500</b> Veff Maxi
Dielectric withstanding voltage		<b>1000</b> Veff mini
Insulation resistance		<b>5000</b> MΩ mini

Stripping mm	a	b	c	d	e	f
	2.16	0.00	0.00	0.00	0.00	0.00

Assembly instruction :

Recommended cable(s)  
KS2

**MECHANICAL CHARACTERISTICS**

Center contact retention		
Axial force – Mating end		<b>27</b> N mini
Axial force – Opposite end		<b>27</b> N mini
Torque		<b>2.8</b> N.cm mini

Cable retention

- pull off	<b>270</b> N mini
- torque	<b>NA</b> N.cm

**TOOLING**

Part Number	Description	Hexagon
R282.286.000	CRIMPING TOOL	-
R282.705.000	POSITIONER	-
R282.255.000	PNEUMATIC CRIMPING TOOL	
R282.711.000	GUIDE	
R282.053.000	STRIPPING TOOL	
R282.066.000	POINTER GAUGE	

Recommended torque		
Mating		<b>NA</b> N.cm
Panel nut		<b>150</b> N.cm
Clamp nut		<b>NA</b> N.cm
A/F clamp nut		<b>0.000</b> mm

Mating life		<b>500</b> Cycles mini
Weight		<b>3.681</b> g

**OTHERS CHARACTERISTICS**

**ENVIRONMENTAL**

Operating temperature		<b>-65/+105</b> °C
Hermetic seal		<b>NA</b> Atm.cm3/s
Panel leakage		<b>NA</b>

Issue : 0540 C

In the effort to improve our products, we reserve the right to make changes judged to be necessary.



**RADIALL**®

**STRAIGHT BULKHEAD JACK PANEL SEAL**

**R125.325.900**

**CABLE .141**

Series : SMA

**COMPONENTS**

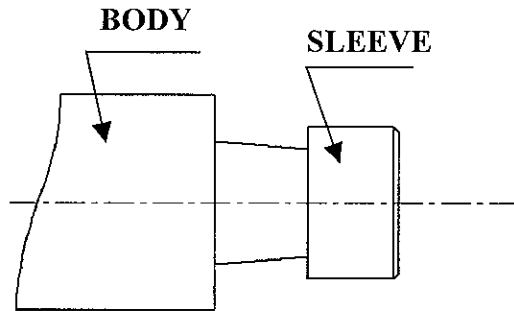

**STIPPING DIMENSIONS**

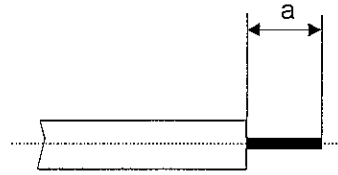

1

- Strip the cable with the cable stripping tool
- Trim the cable inner conductor with the trimmer.
- Clean the cable

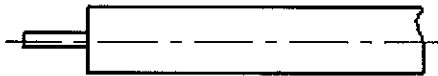

3

- Insert the connector and the cable on the crimping tool with guide and positioner.
- A pneumatic crimping tool exist too that can be used

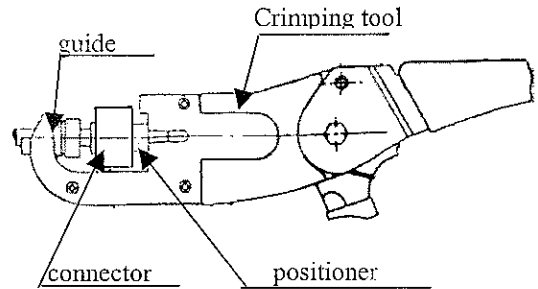

2

- Slide connector onto the cable

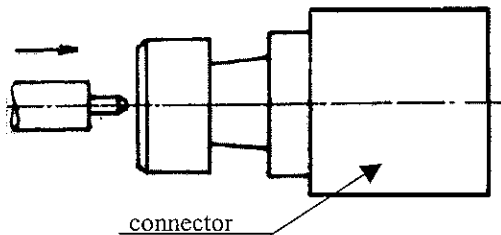

4

- Press the connector on the cable.

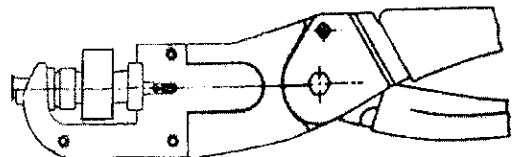

Issue : 0540 C

In the effort to improve our products, we reserve the right to make changes judged to be necessary.



**RADIALL**®